

## Technical specification sheet

# HAC 30 H 15 | Aluminium Cylinder

Specifications		
article number		100.122.080
short description		Aluminium Cylinder
model		HAC 30 H 15
max. working pressure	bar/Mpa	720 / 72
tonnage	t	30
stroke	mm	150
closed height	mm	297
capacity	kN/t	318.1 / 32.4
effective pressure area (press)	cm <sup>2</sup>	44.2
effective pressure area (retract)	cm <sup>2</sup>	11
required oil content (effective)	cc	497
required oil content (press)	cc	662
required oil content (retract)	cc	165
connection		A 118
cylinder type		standard
acting type		double
return type		hydraulic
material		aluminium
weight, ready for use	kg	10.2
ASME		B30.1

Technical drawing dimensions		
dimension A	mm	297
dimension B	mm	125
dimension C	mm	65
dimension D1	mm	76
dimension D2	mm	76
dimension E	mm	28
dimension F	mm	291.5
dimension P	mm	72
I type		[I2]

Standard supplied with	
• High Flow female coupler A 118	
• Flat saddle	

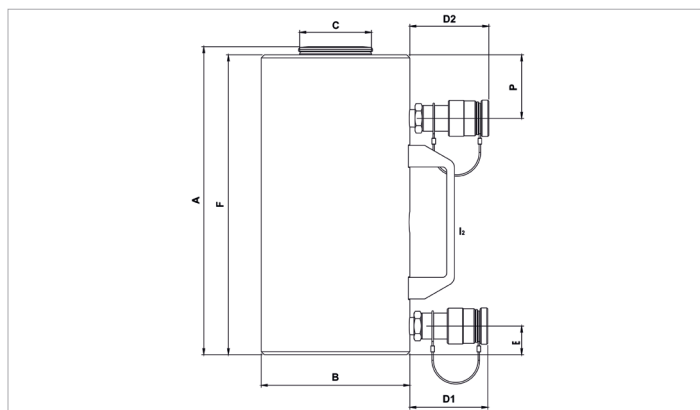

holmatro.com

© Holmatro 2021-09-11

While the greatest care has been devoted to the content, it is possible that the information in this printed matter is incorrect or incomplete. Holmatro B.V. and its affiliated companies (hereafter: Holmatro) cannot be held liable in any way for the consequences of activities undertaken on the basis of this printed matter. Values can vary within the manufacturer measurements. If you have any doubts about the correctness or completeness of the information, you shall contact Holmatro (T +31 (0)162-751480). Nothing from this printed matter can be copied and/or made public in any way without the explicit authorisation of Holmatro.