

Technical Data

Design :	Pneumatic double-piston quarter turn actuator
Design features :	Rack-and-pinion system, piston guide via guide rods
Angle of rotation :	0°-90°
Air pressure supply :	mind. 2 bar, max. 10 bar
Operating medium :	Dry and filtered compressed air
Ambient temperature :	-25°C to +80°C
Mounting position :	any
Resistance to corrosion :	Industrial atmosphere
Lubrication :	Life time lubrication with grease ISO 51825-K2K-30
Seals :	NBR-O-Rings, 70 Shore
Coatings :	Housing anodized and colour sealed End caps - CED cathodic electrodeposition
Maintenance and inspection :	AMG actuators are free of maintenance within the life time. Provided that: <ul style="list-style-type: none"> • the actuator is properly mounted • the operating medium used is clean and non-aggressive • the actuator is operated under normal ambient conditions • the actuator is used in compliance with the intended use (see assembly and maintenance manual)
Applied standard:	DIN EN ISO 5211, DIN EN 15714-3, VDI / VDE 3845, DIN 79
Options:	Extended angle of rotation 120°, 135°, 180° Adjustable inner / outer travel stops up to +/- 5° via travel-stop-module (BR03C-DE) Ambient temperature up to +100°C (BR03C-HT Version) Ambient temperature down to -40°C (BR03C-TT Version) Sealing elements made of FKM (viton) or alternatively fluorosilicone Tailor made mounting kits and dimensioning acc. To customer requirements Variable cycle times (fast / slow) Variable sens of rotation (clockwise / counterclockwise) Coating options: Hard-Coat, chemical nickelplating, plastic coating, special lacquer



SAF

SAD

Size	45	
Weight [kg]		
Type SAD	75,0	
Type SAF	102	
Stroke volume [dm³]		
Type SAD	25,6	
Type SAF	14,7	
Operating times [sec.] ¹⁾		
Type SAD OPEN	4,0	
Type SAD CLOSE	4,0	
Type SAF ²⁾ OPEN	7,0	
Type SAF ²⁾ CLOSE	3,0	

1) operating times at 4,5 bar air pressure supply without load (standard values)

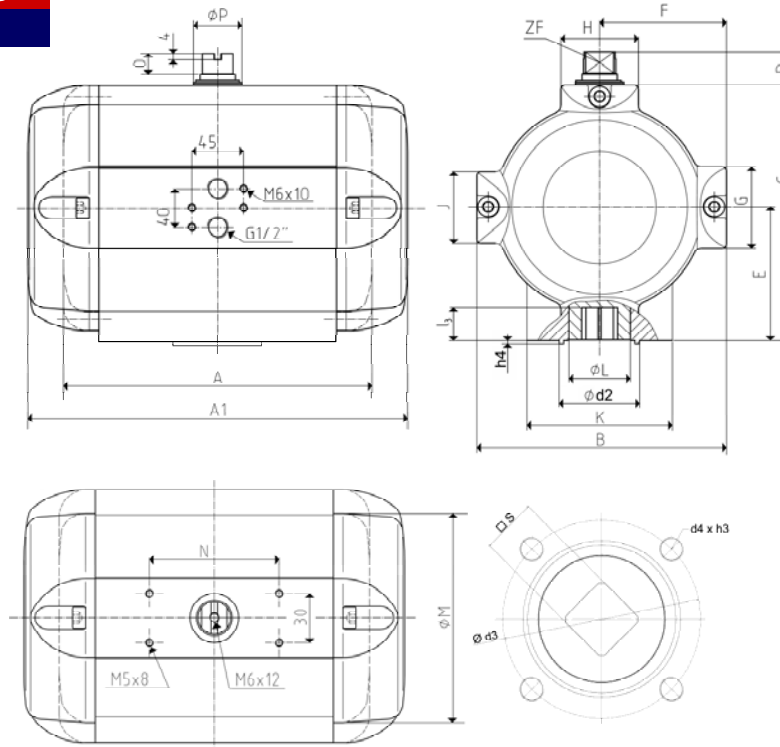
2) Type SAF with 9 springs



Design	SAD / SAF
Size	45
A (double-acting)	475
A1 (single-acting)	695
B	330
C	337
D	30
E	175
F	165
G	84
H	125
K	150
phi L	106
J	84
phi M	292
N	130
O	18
phi P	90
ZF	46
Connection ISO 5211	F16
phi d2	130
phi d3	165
d4 x h3	M20x32
number of bolts	4
h4	5
l3	50
s	46

Type	number of springs n	spring-torque Ms [Nm]	air torque Ma [Nm] at operating pressure pe [bar]																																								
			2 bar		2,5 bar		3 bar		3,5 bar		4 bar		4,5 bar		5 bar		5,5 bar		6 bar		6,5 bar		7 bar		7,5 bar		8 bar																
			MIN	MAX	MIN	MAX	MIN	MAX	MIN	MAX	MIN	MAX	MIN	MAX	MIN	MAX	MIN	MAX	MIN	MAX	MIN	MAX	MIN	MAX	MIN	MAX	MIN	MAX	MIN	MAX													
SAD 45	-	-	<table border="1"> <tr> <td>893</td><td>1156</td><td>1419</td><td>1674</td><td>1934</td><td>2199</td><td>2457</td><td>2717</td><td>2980</td><td>3245</td><td>3495</td><td>3744</td><td>3994</td> </tr> </table>																												893	1156	1419	1674	1934	2199	2457	2717	2980	3245	3495	3744	3994
893	1156	1419	1674	1934	2199	2457	2717	2980	3245	3495	3744	3994																															
SAF 45	4	352 585	308 541	571 804	834 1067	1089 1322	1349 1582	1614 1847	1872 2105	2132 2365	2395 2628	2660 2893	2910 3143	3159 3392	3409 3642																												
	5	440 732	161 453	424 716	687 979	942 1234	1202 1494	1467 1759	1725 2017	1985 2277	2248 2540	2513 2805	2763 3055	3012 3304	3262 3554																												
	6	528 878		278 628	541 891	796 1146	1056 1406	1321 1671	1579 1929	1839 2189	2102 2452	2367 2717	2617 2967	2866 3216	3116 3466																												
	7	616 1025		131 540	394 803	649 1058	909 1318	1174 1583	1432 1841	1692 2101	1955 2364	2220 2629	2470 2879	2719 3128	2969 3378																												
	8	705 1171			248 714	503 969	763 1229	1028 1494	1286 1752	1546 2012	1809 2275	2074 2540	2324 2790	2573 3039	2823 3289																												
	9	793 1317			102 626	357 881	617 1141	882 1406	1140 1664	1400 1924	1663 2187	1928 2452	2178 2702	2427 2951	2677 3201																												
	10	881 1464				210 793	470 1053	735 1318	993 1576	1253 1836	1516 2099	1781 2364	2031 2614	2280 2863	2530 3113																												
	11	969 1610				64 705	324 965	589 1230	847 1488	1107 1748	1370 2011	1635 2276	1885 2526	2134 2775	2384 3025																												
	12	1057 1756					178 877	443 1142	701 1400	961 1660	1224 1923	1489 2188	1739 2438	1988 2687	2238 2937																												
	Sonderausführung																																										
13	1145 1908								291 1054	549 1312	809 1572	1072 1835	1337 2100	1587 2350	1836 2599	2086 2849																											
14	1233 2049								150 966	408 1224	668 1484	931 1747	1196 2012	1446 2262	1695 2511	1945 2761																											